

PIALBA ACTIVE HUB

SKATEPARK AND PARKOUR

FOR COMMUNITY INFORMATION

CONCEPT DESIGN - DECEMBER 2018



CONSULTATION SUMMARY

The following survey results are from a community consultation process undertaken 26-27th of July 2018. Participants responded in conversation and to a survey questionnaire, about a proposed Skatepark and Parkour space at Pialba Foreshore.

Council Officers and with Councillors present. Playce and a Council Officer conducted further consultation at three high schools and one primary school on the following day 27.08.18. Through this process an additional 43 participants had their say.

Public consultation was conducted at Hervey Skatepark on the 26.08.18. With over 30 attendees, 25 participated in completing surveys. The consultation was run by Playce,

The following information documents survey results from both days of consultation.

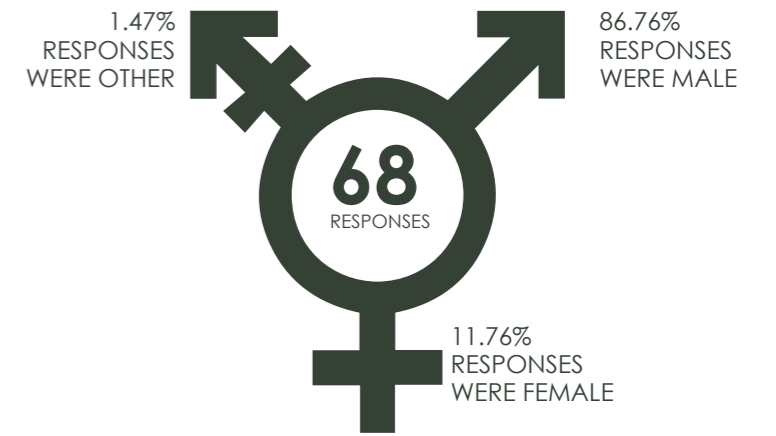

PARKOUR



40% ARE INTERESTED IN VAULTS AND CLIMBING WALLS

"I like parkour because you discover new things." Feedback

"I love climbing. Since i have been to various rock climbing centres and i believe it would help me improve my skills." Feedback

TOP 5 PICKS

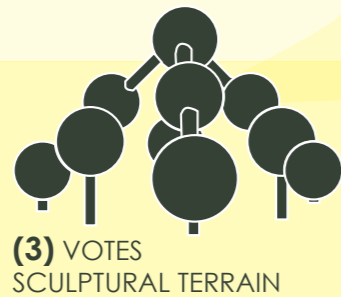

(4) VOTES WALLS

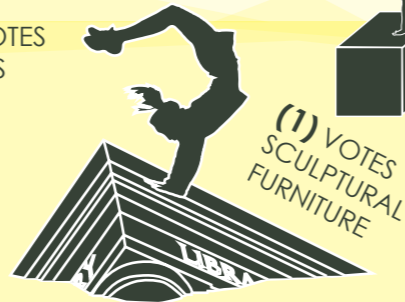

(5) VOTES BLOCKS

(2) VOTES OPEN/GAPS

AGE

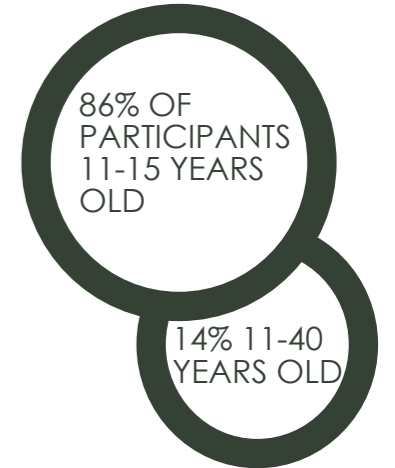

SKATE

"Fun to roll around riding bike, scooter or skateboard." Feedback

"Try to accommodate all ages and consider users of all types of skate/bike interaction." Feedback

WHAT SKATE PARKS DO YOU GO TO?
Hervey Bay 75%
Maryborough 25%

"Aboriginal graffiti on the ramps -lights at the skatepark."

"Less packed like Hervey Bay skate park, more spaced out so it allows more accessibility to skateboarders and bmx riders".

66% ARE INTERESTED IN TRANSITION STYLE



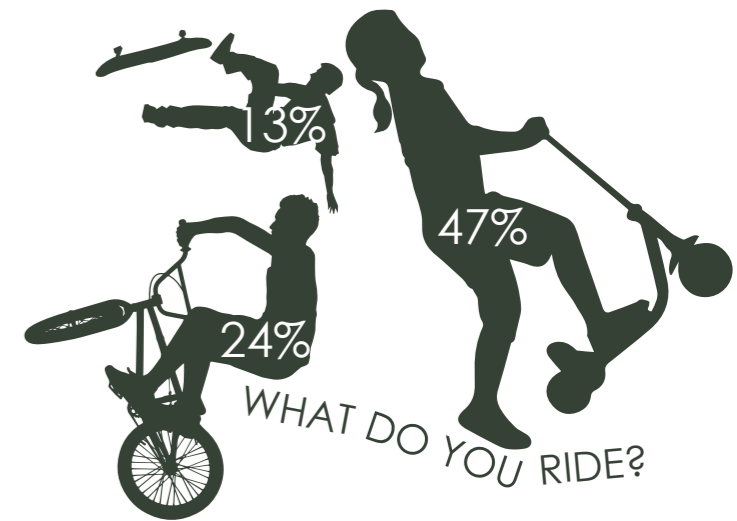
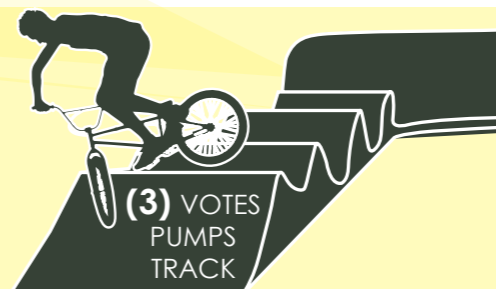
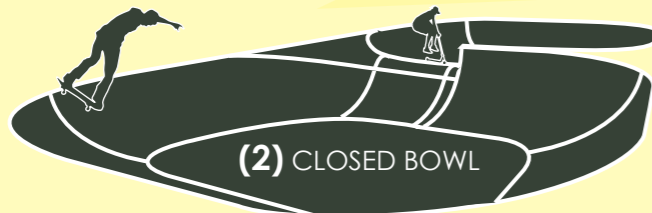
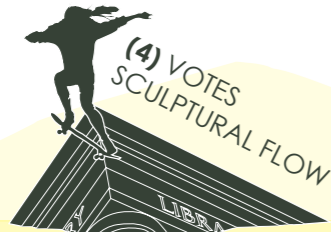







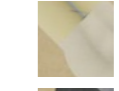
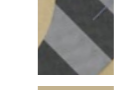

TOP 5 PICKS

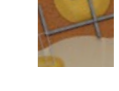

CONTEXT PLAN

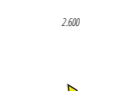
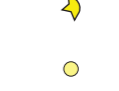

LEGEND

-  SITE BOUNDARY
-  PROPOSED GARDEN BED BATTER (MAX 1:3 FALL)
-  SKATE PARK BOWL
-  SKATE PARK PLAZA
-  PROPOSED PATH CONNECTION
-  EXISTING PATH TO BE REALIGNED (TBC)
-  SHELTER WITH BENCH SEATS
-  PARKOUR FEATURE WITH SOFT FALL RUBBER AND SAND
-  PROPOSED SKATEPARK DRAINAGE
-  PEDESTRIAN ACCESS POINT (TBC)
-  EXISTING SEWER LINE
-  PROPOSED SPOT LEVEL
-  PROPOSED LIGHTS
-  EXISTING LIGHT POST - TO BE RELOCATED
-  PROPOSED TREE

PIALBA ACTIVE HUB
CONCEPT DESIGN
FOR COMMUNITY INFORMATION



DEC 2018

CONCEPT PLAN

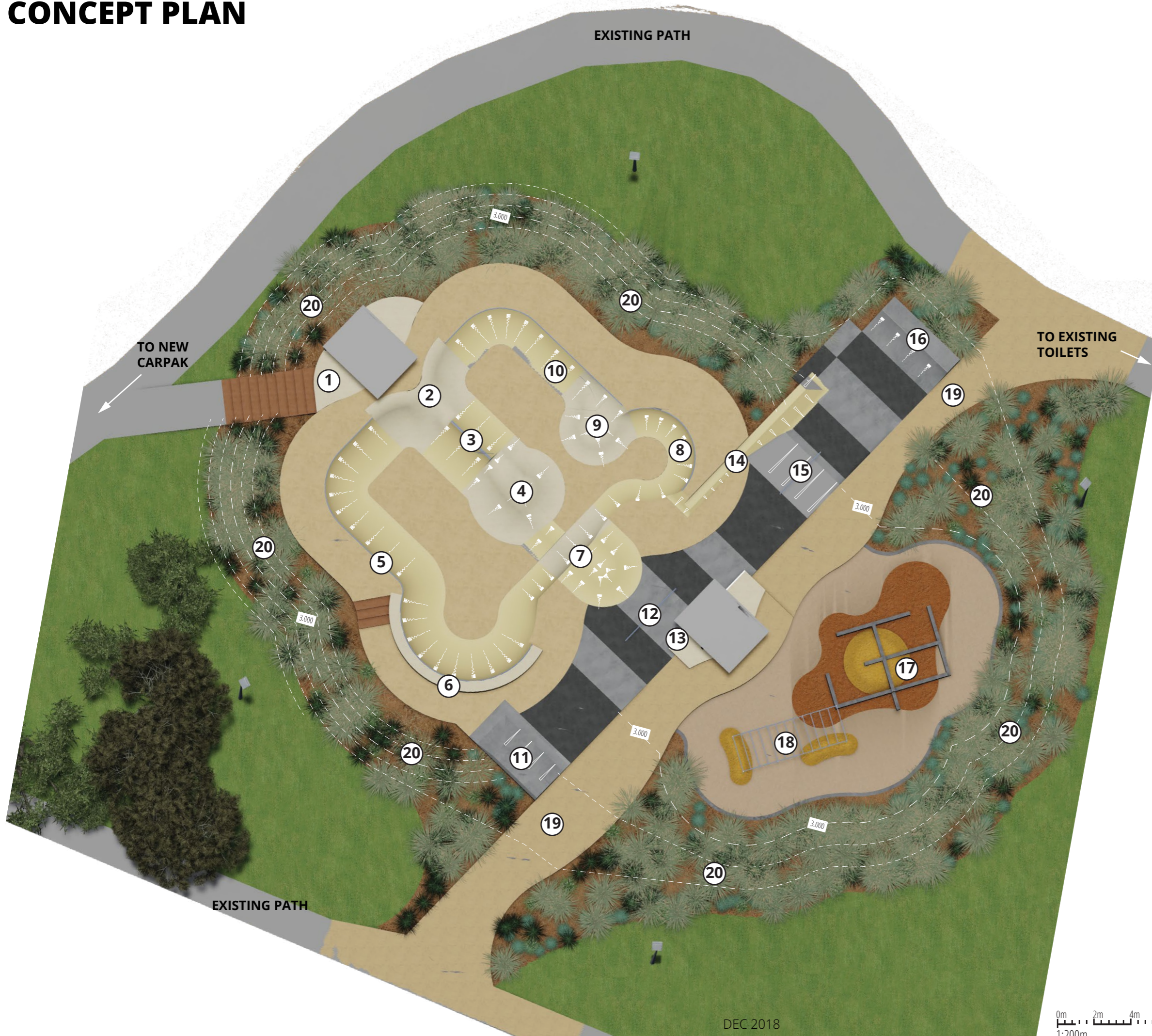

BOWL FEATURES

- ① SOCIAL AREA WITH SHELTER AND BENCH SEATS
- ② 1200-1800H ROLL-IN
- ③ 1200-1800H SPINE
- ④ 1000-1600H MOGUL
- ⑤ 1800H QUARTER PIPE
- ⑥ 2250H ELEVATOR POCKET
- ⑦ 1200H QUARTER PIPE TO 600H MOGUL
- ⑧ 1200H "TIGHT" POCKET
- ⑨ 600H MOGUL
- ⑩ 1200H QUARTER PIPE

PLAZA FEATURES

- ⑪ 500H BANK
- ⑫ 375H 4m L ROUND FLAT RAIL
- ⑬ 400H LEDGE TO SOCIAL AREA WITH SHELTER AND BENCH SEATS
- ⑭ 200H - 800H BANKED LEDGE
- ⑮ WITH 450H ROUND DOWN RAIL 600H BANK
- ⑯ 900H QUARTER PIPE

PARKOUR FEATURES

- ⑰ PARKOUR VAULTS (0.6m-1.2m) WITH RUBBER MOUNDS
- ⑱ ACCESS PATH 1:21 GRADE
- ⑲ PARKOUR OVERHEAD BARS
- ⑳ GARDEN BED BATTER (MAX 1:3 FALL)

PIALBA ACTIVE HUB
CONCEPT DESIGN
FOR COMMUNITY INFORMATION



DEC 2018

CONCEPT OVERVIEW



DEC 2018

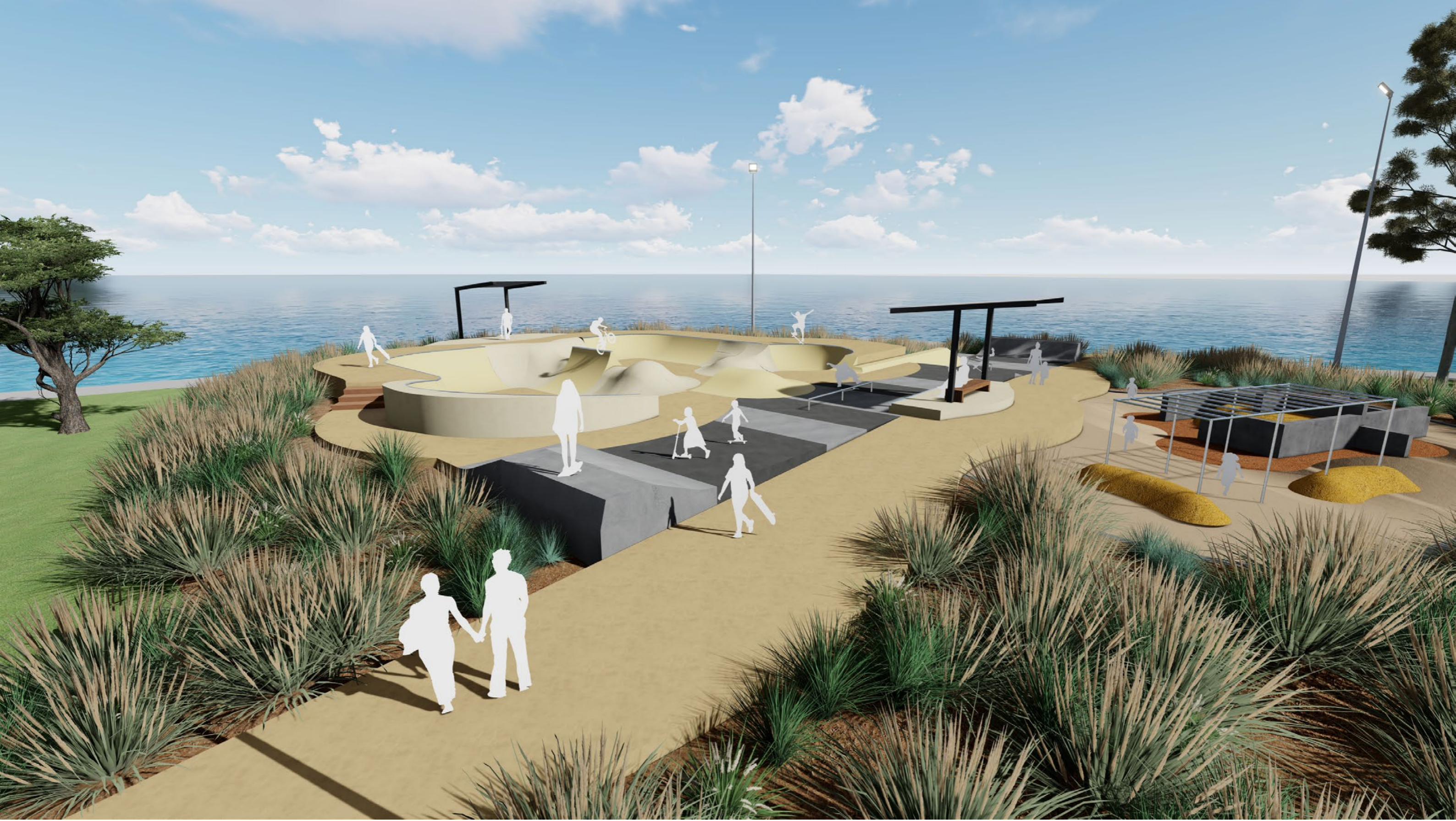

DEC 2018



DEC 2018



DEC 2018



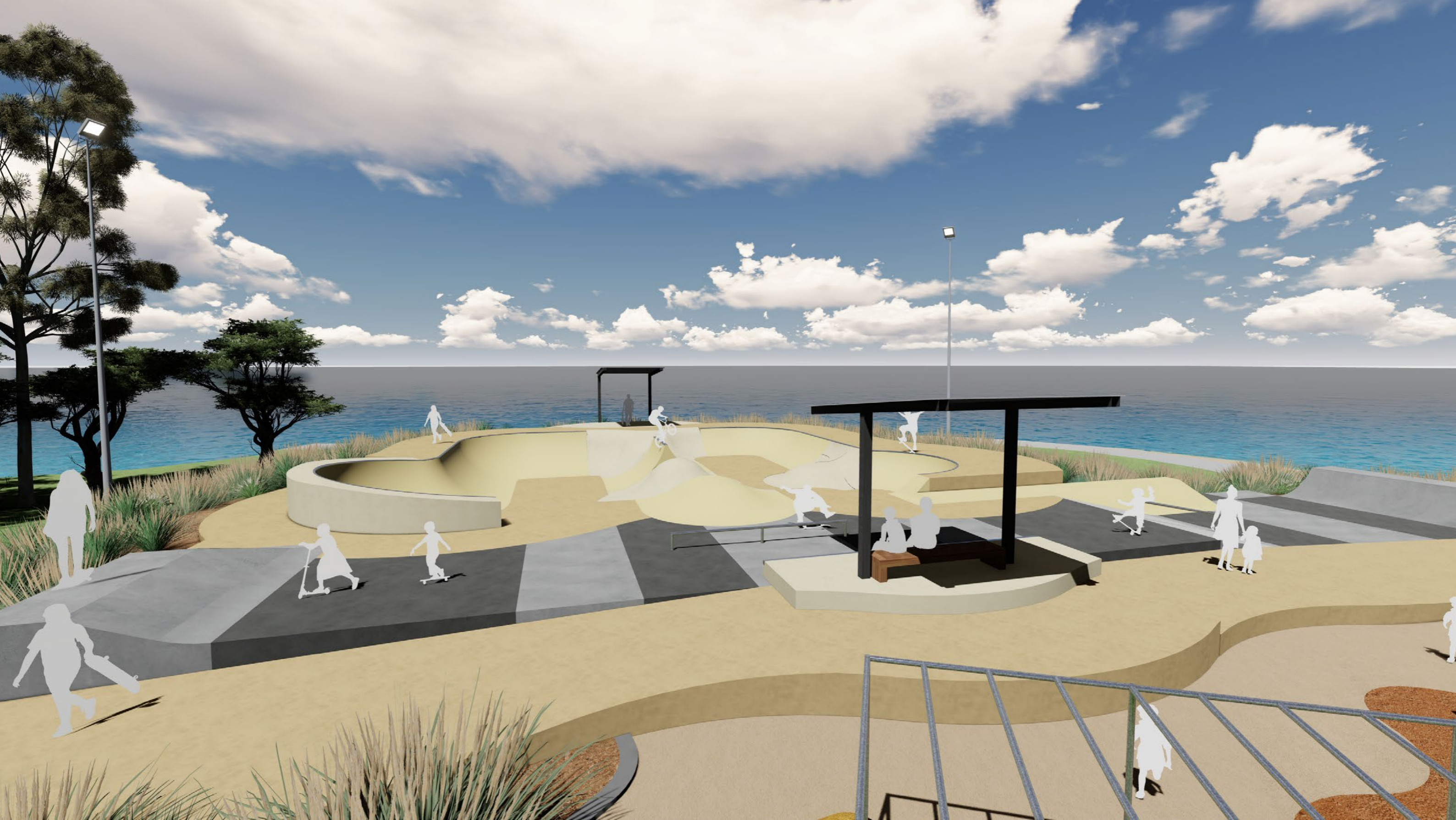

DEC 2018



DEC 2018