



Date: 5th November 2020 **Author:** Selwyn Pohoiwi **Project:** Adelaide Street Water Main Upgrade
Rev #: 2 **TMD Number:** OP 242 **MUTCD Release Date:** November 2019
MUTCD Figure: 5-1.28 **TGS:** FCRC-ADELAIDE 3002-2020 **Stage:** Western Side Day Works

Comments:

- Works To Include: Water Main Upgrade & Associated Roadworks
- Works to take place between - 0700 - 1700hrs
- Workman signage to be closed when works not in progress
- Any conflicting signage to be covered whilst speed reductions in place
- All hazardous areas to be barricaded off at all times.
- Footpath shall be open with clearly designated pedestrian routes at all times and risk assessed at daily prestart meeting

Posted Speed

Table 4.2 – Value of dimension D

Selected	Speed limit ¹ (km/h)	Dimension D (m)
	40 or less	5 to 10
	50	10 to 15
✓	60	15 to 45
	70, 80	60 to 80
	90, 100	80 to 100
	110	100 to 120

NOTE: The permanent Posted Speed Limit on the section of road subject to roadwork before commencement of roadworks.

Legend

- 700mm Cones Or Bollards
- Work Area

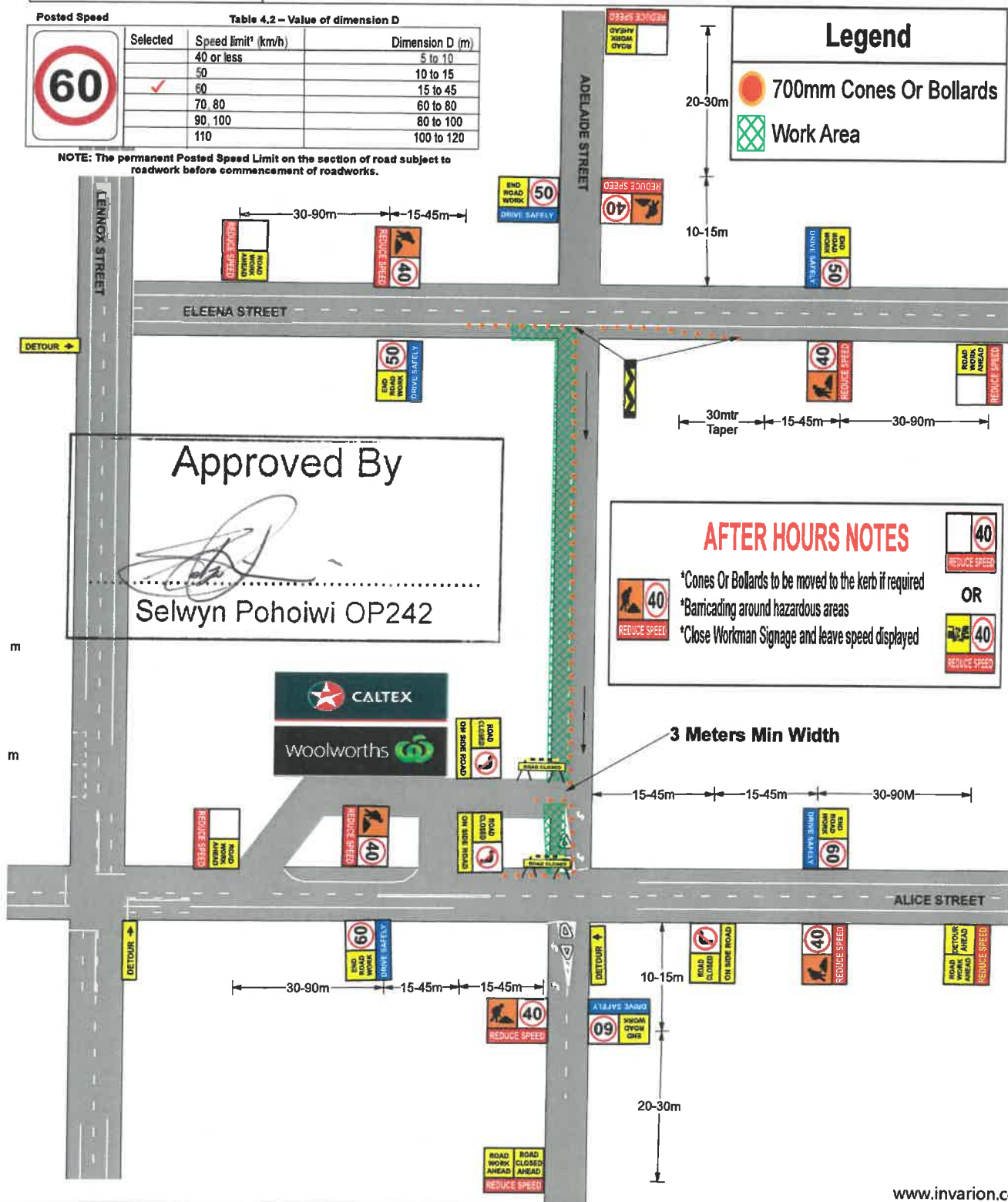

Approved By

Selwyn Pohoiwi OP242

AFTER HOURS NOTES

- *Cones Or Bollards to be moved to the kerb if required
- *Barricading around hazardous areas
- *Close Workman Signage and leave speed displayed

