



Date: 5th November 2020 Author: Selwyn Pohoiwi Project: Adelaide Street Water Main Upgrade  
 Rev #: 2 TMD Number: OP 242 MUTCD Release Date: November 2019  
 MUTCD Figure: 5-1.29 TGS: FCRC-ADELAIDE 3003-2020 Stage: Night Works

**Comments:**

- Works To Include: Water Main Upgrade & Associated Roadworks
- Works to take place between - 1800 - 0600hrs
- Workman signage to be closed when works not in progress
- Any conflicting signage to be covered whilst speed reductions in place
- All hazardous areas to be barricaded off at all times.
- Footpath shall be open with clearly designated pedestrian routes at all times and risk assessed at daily prestart meeting

**Posted Speed**

**Table 4.2 – Value of dimension D**

Selected	Speed limit <sup>1</sup> (km/h)	Dimension D (m)
	40 or less	5 to 10
✓	50	10 to 15
	60	15 to 45
	70, 80	60 to 80
	90, 100	80 to 100
	110	100 to 120

**NOTE:** The permanent Posted Speed Limit on the section of road subject to roadwork before commencement of roadworks.

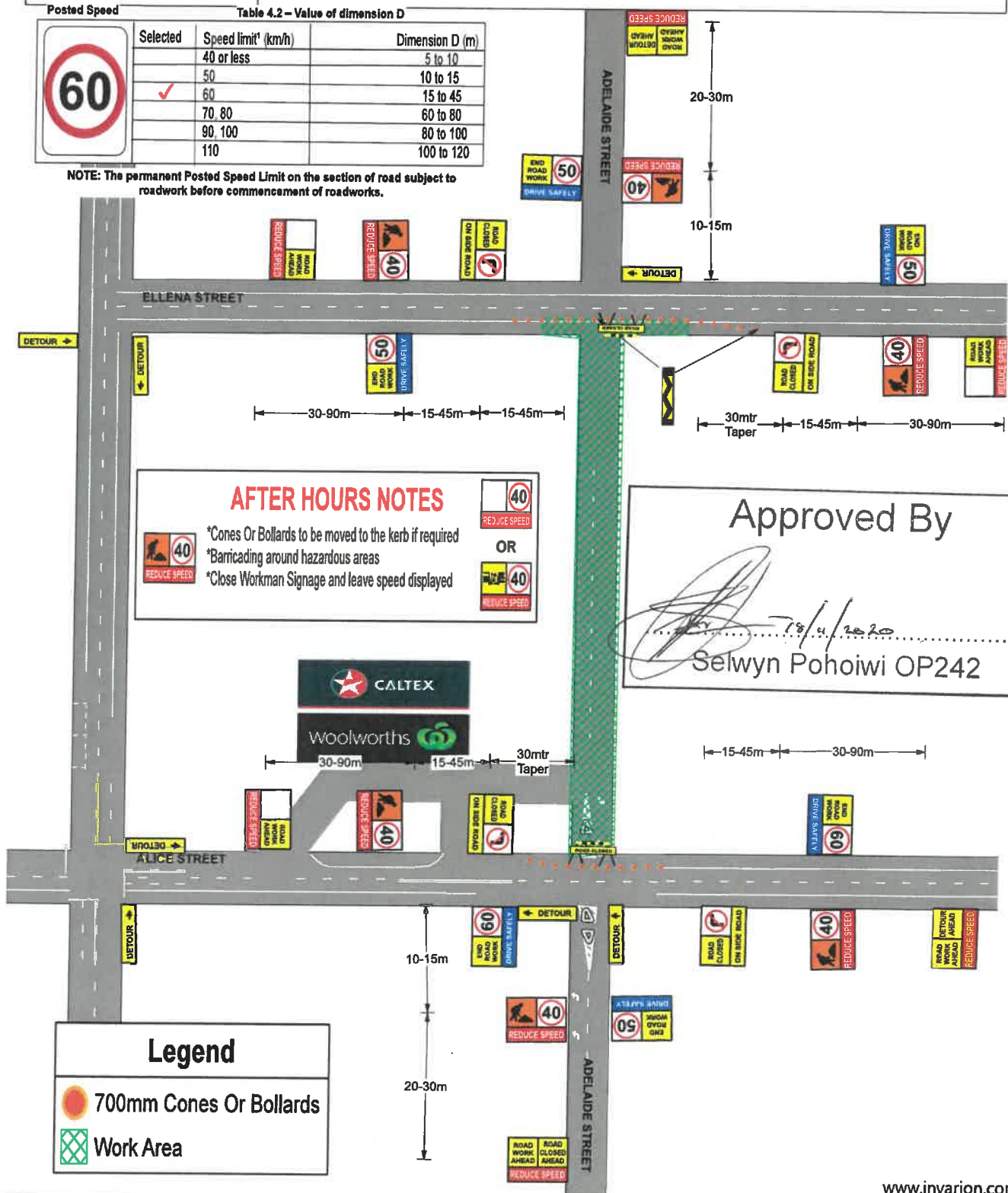

**AFTER HOURS NOTES**

- \*Cones Or Bollards to be moved to the kerb if required
- \*Barricading around hazardous areas
- \*Close Workman Signage and leave speed displayed

Approved By

*[Signature]*  
 7/11/20  
 Selwyn Pohoiwi OP242

**Legend**

- 700mm Cones Or Bollards
- Work Area