

Road Reconstruction — Eatonvale Road (Rosehill Road to Amador Road)

PROJECT:

This project provides for road reconstruction works of approximately 810m of roadway along Eatonvale Road, between Rosehill Road and Amador Road.

The road reconstruction works are being undertaken as a result of inspections carried out as part of Council's ongoing asset inspection program which identified that the road was showing signs of pavement failure and distress.

PROJECT ESTIMATE:

\$980,000 (this project is partly funded through the State Government's Transport Infrastructure Development Scheme)

PROJECT SCOPE OF WORKS:

The Project scope is as follows:

- Earthworks and excavation;
- Stormwater cross-drainage;
- Pavement and bitumen surfacing;
- Linemarking and signage;
- Top dressing and turfing of disturbed areas.



The traffic management plan that will be put in place for the duration of the construction period will be developed prior to works commencing.

INDICATIVE PROJECT MILESTONES

May 2020	Final Design
May/June 2021	Tender Period
June/Sept 2021	Construction Period
October 2021	Project Completion

Note: Project milestones are subject to contract and weather and may change.

Road Reconstruction — Eatonvale Road v(Rosehill Road to Bruce Highway)

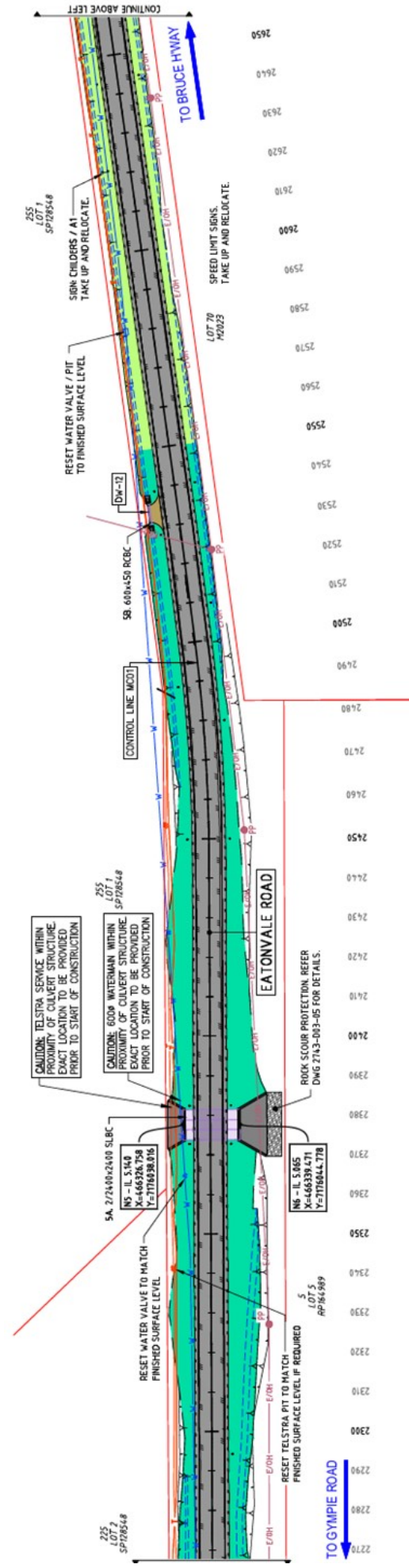
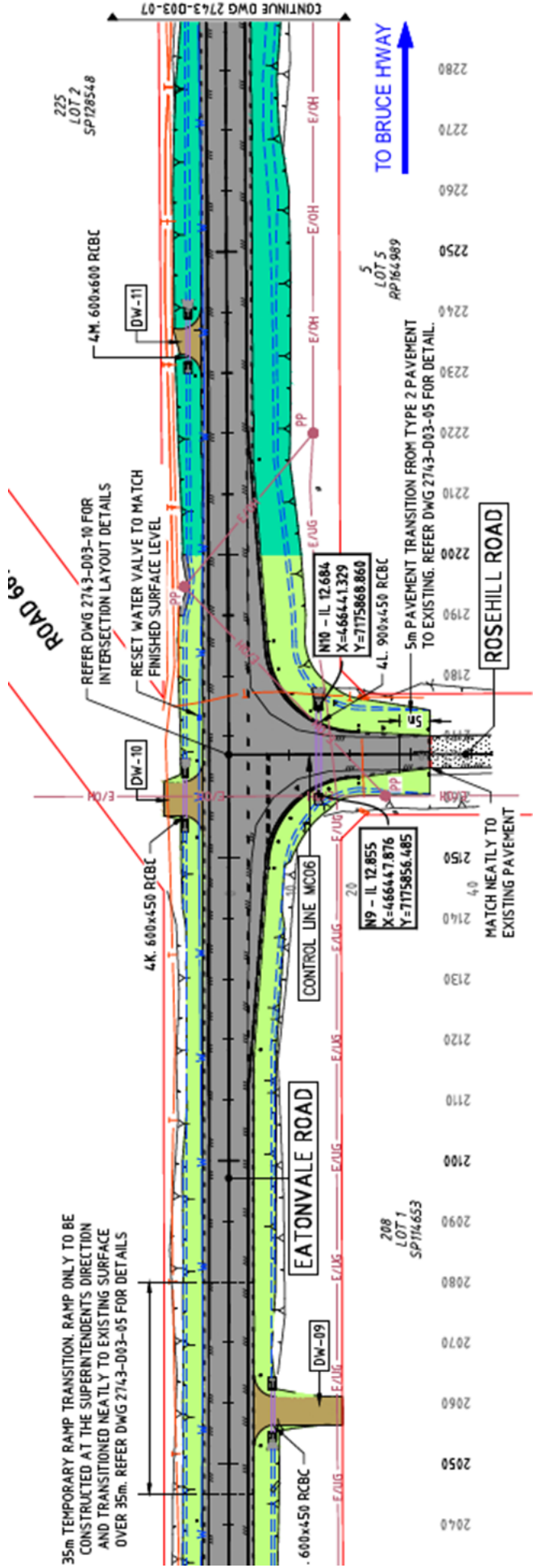

LEGEND - EXISTING		LEGEND - PROPOSED	
E/O/S	EXISTING ELECTRICITY LINE U/G	PROG. CONTROL LINE	PROP. PAVEMENT TYPE 1
E/O/H	EXISTING ELECTRICITY LINE D/H	PROP. BOTTOM OF BATTER	PROP. PAVEMENT TYPE 2
PP	EXISTING POWERPOLE	PROP. TOP OF BATTER	PROP. PAVEMENT TRANSITION
T	EXISTING TELSTRA LINE/PIT	PROP. CHANGE OF GRADE	PROP. AREA OF TURF
M	EXISTING WATERMAIN / METER	PROP. DRAINAGE SWALE	PROP. AREA OF JUTE MESH AND HYDROMULCH
	EXISTING LOT BOUNDARY	PROP. PRIVATE ACCESS	PROP. DRIVEWAY REFERENCE

