

# Reverse Flow Lane Closure & Road Closure

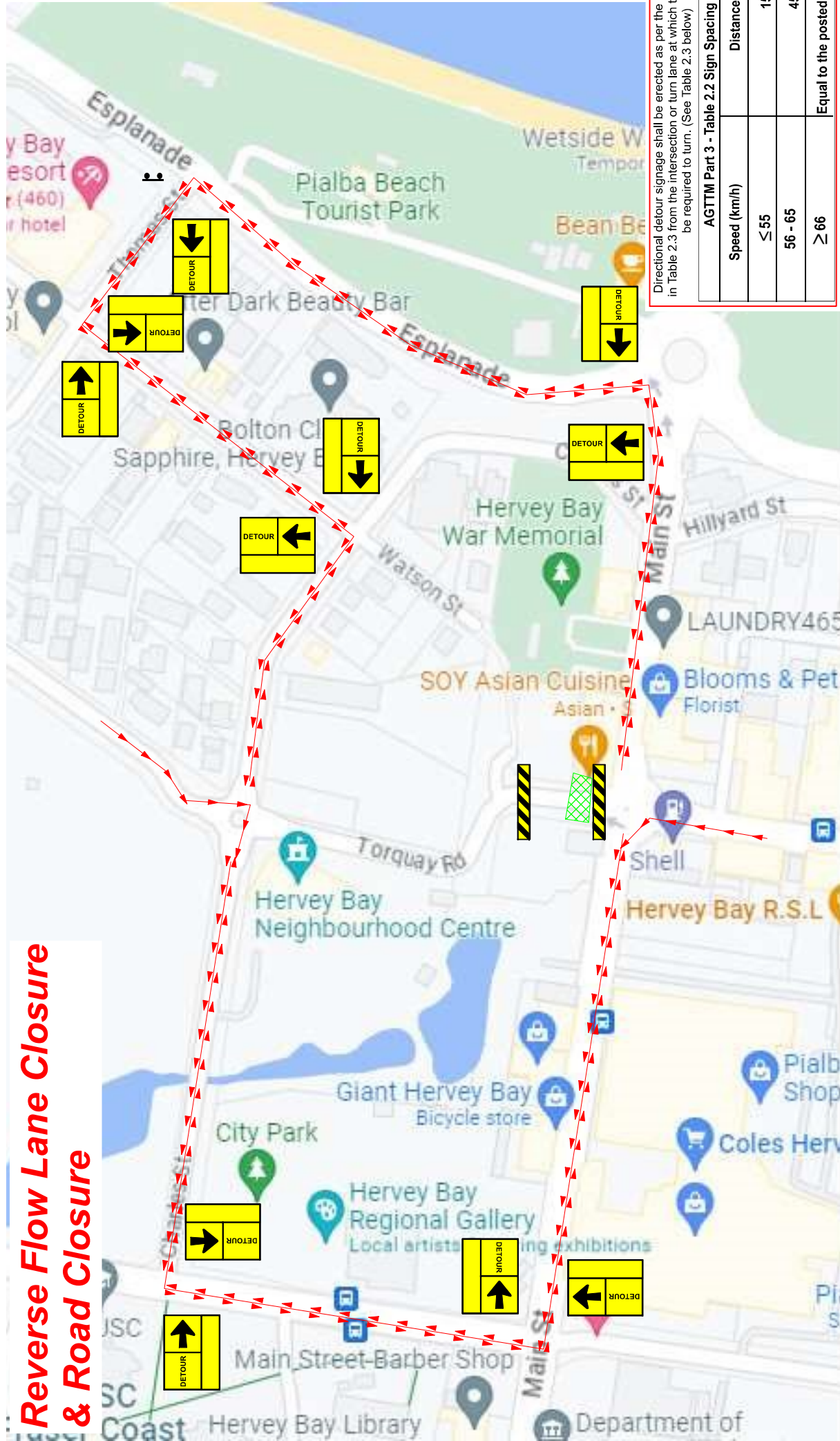

Directional detour signage shall be erected as per the distances in table 2.3 from the intersection or turn lane at which traffic shall be required to turn. (See Table 2.3 below)

AGTMM Part 3 - Table 2.2 Sign Spacing	
Speed (km/h)	Distance (m)
≤ 55	15
56 - 65	45
≥ 66	Equal to the posted speed limit

**DISCLAIMER:**  
 This TGS has been prepared in accordance with the information supplied by the PCBU. Technical due care has been applied in the collation of the relevant information on which this TGS is based. The TM Design professional is not responsible for any omissions or errors in the base information supplied. All care has been taken to ensure that the information in this TGS is accurate at the time of the works may vary from those established in the development of the TGS. The PCBU is responsible for undertaking an evaluation of the site and traffic conditions against the application constraints outlined within this TGS. The TGS shall not be used. This TGS shall only be applied under the circumstances depicted, and cannot be used otherwise. As required by PCBU in accordance with the Transport Infrastructure Act 1994, and to the requirements of the Transport Infrastructure Act 1994, the PCBU is required to occupy a road corridor. This TGS shall not be utilised for works conducted outside permit conditions.



SHIELD TRAFFIC  
-PROTECTING YOU-



Fraser Coast  
REGIONAL COUNCIL

<b>PROJECT DETAILS</b>	<b>PROJECT NAME:</b> Mains St Cabling Works	<b>Contract Number:</b> 0400 760 914
	<b>Designer Name:</b> Damien Keller	<b>Signature:</b> 
	<b>Location:</b> (Road Name, Suburb) Torquay Rd, Pialba	<b>and:</b> Charles St
	<b>Date &amp; Time:</b> As required by PCBU	<b>Control Method:</b> Reverse Flow Lane Closure & Road Closure
	<b>Project Scope:</b> Underground Cabling	

<b>DESIGNER</b>	<b>Nominated Traffic Officer:</b> Damien Keller TMD open # 205 Mob: 0428 668 253
<b>REV. DATE</b>	<b>AMENDMENT</b>
01	Update to join Works Areas
<b>REVISION HISTORY</b>	

<b>TGS #</b>	<b>STOP &amp; DIAL</b>
7540pg3	000
<b>REV. 01</b>	<b>RESOURCE REQUIREMENTS</b>
<b>TC:</b>	<b>UTE:</b>
See Page 1	See Page 1
<b>Traffic Cones:</b>	<b>Sign Frames:</b>
See Page 1	See Page 1
<b>OTHER:</b>	<b>Police Officer(s)</b>
See Page 1	

**PLAN NOT TO SCALE**