

## Kerb and Channel Sectional Replacement – Queen Street (326-332 Queen Street, Maryborough)

### PROJECT:

This project provides for the replacement of the kerb and channel on the southern side of Queen Street between 326 and 332 Queen Street, Maryborough.

The works are being undertaken as a result of Council's ongoing asset inspection program which identified that the kerb and channel was showing signs of failure and distress.

### PROJECT ESTIMATE:

\$150,000

### PROJECT SCOPE OF WORKS:

The project scope is as follows:

- Excavation and earthworks;
- Replacement of existing kerb and channel on the southern side of Queen Street between 326 and 332 Queen Street, Maryborough;
- Reconstruction of 4 existing vehicle crossovers at 326x2, 330 and 332 Queen Street Maryborough. *(Note: reinstatement works to be completed in plain concrete only);*
- Replacement of a section of driveway at 332 Queen Street and 330 Queen Street, Maryborough; *(Note: reinstatement works to be completed in plain concrete only);*
- Subsoil drainage works;
- Reconnection of stormwater to outlets;
- Construction of two new stormwater inlets in front of properties located at 334 Queen Street and 326 Queen Street;
- Removal of a tree on the footpath outside of 332 Queen Street, Maryborough;
- Topdressing and turfing of disturbed areas.



The traffic management plan that will be put in place for the duration of the construction period will be developed prior to works commencing.

#### INDICATIVE PROJECT MILESTONES

April 2025	Final Design
July 2025	Construction Period
Aug 2025	Project Completion

Note: Project milestones are subject to weather and may change.

## Kerb and Channel Sectional Replacement – 326-332 Queen Street, Maryborough

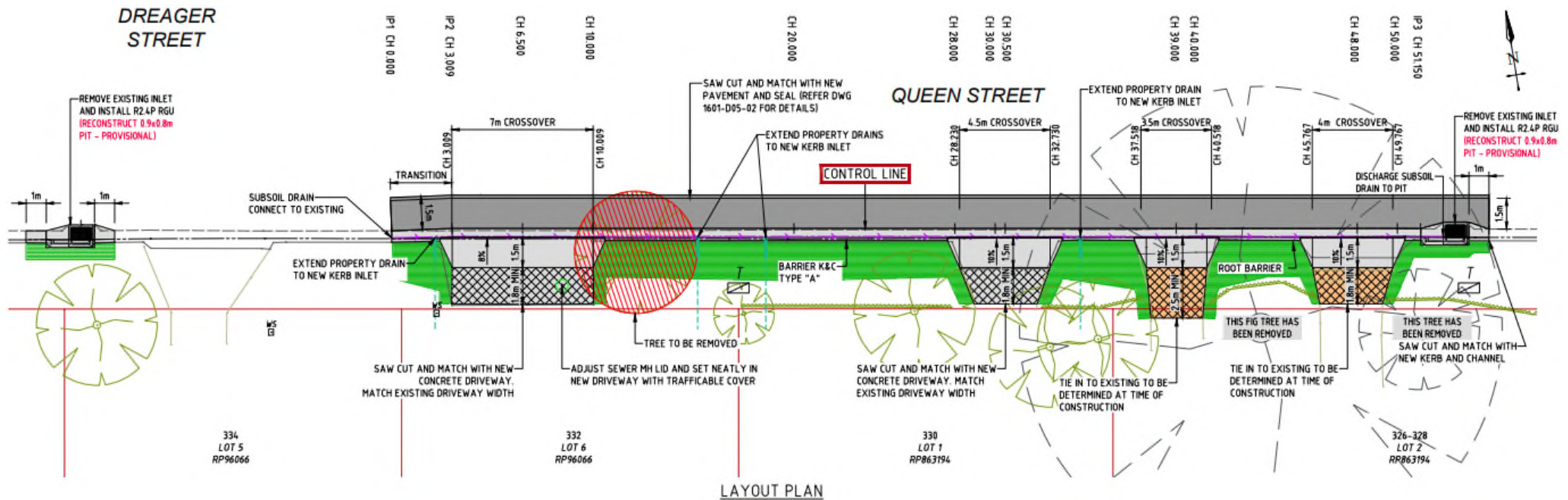

### LEGEND - NEW WORKS



NEW RESIDENTIAL DRIVEWAY  
SL72 MESH, 125mm THICK



NEW RESIDENTIAL DRIVEWAY  
(PROVISIONAL)



NEW PAVEMENT /SEAL



TOP SOIL & TURF



DRIVEWAY CROSSOVER



BARRIER K&C TYPE "A"



ROOF DRAIN EXTENSION  
AND KERB INLET



EXIST ROOF WATER DRAINS



SUBSOIL DRAIN



TREE TO BE REMOVED



## Kerb and Channel Sectional Replacement – Queen Street (326-332 Queen Street, Maryborough)

### PROJECT:

This project provides for the replacement of the kerb and channel on the southern side of Queen Street between 326 and 332 Queen Street, Maryborough.

The works are being undertaken as a result of Council's ongoing asset inspection program which identified that the kerb and channel was showing signs of failure and distress.

### PROJECT ESTIMATE:

\$150,000

### PROJECT SCOPE OF WORKS:

The project scope is as follows:

- Excavation and earthworks;
- Replacement of existing kerb and channel on the southern side of Queen Street between 326 and 332 Queen Street, Maryborough;
- Reconstruction of 4 existing vehicle crossovers at 326x2, 330 and 332 Queen Street Maryborough. *(Note: reinstatement works to be completed in plain concrete only);*
- Replacement of a section of driveway at 332 Queen Street and 330 Queen Street, Maryborough; *(Note: reinstatement works to be completed in plain concrete only);*
- Subsoil drainage works;
- Reconnection of stormwater to outlets;
- Construction of two new stormwater inlets in front of properties located at 334 Queen Street and 326 Queen Street;
- Removal of a tree on the footpath outside of 332 Queen Street, Maryborough;
- Topdressing and turfing of disturbed areas.



The traffic management plan that will be put in place for the duration of the construction period will be developed prior to works commencing.

#### INDICATIVE PROJECT MILESTONES

April 2025	Final Design
July 2025	Construction Period
Aug 2025	Project Completion

Note: Project milestones are subject to weather and may change.

## Kerb and Channel Sectional Replacement – 326-332 Queen Street, Maryborough

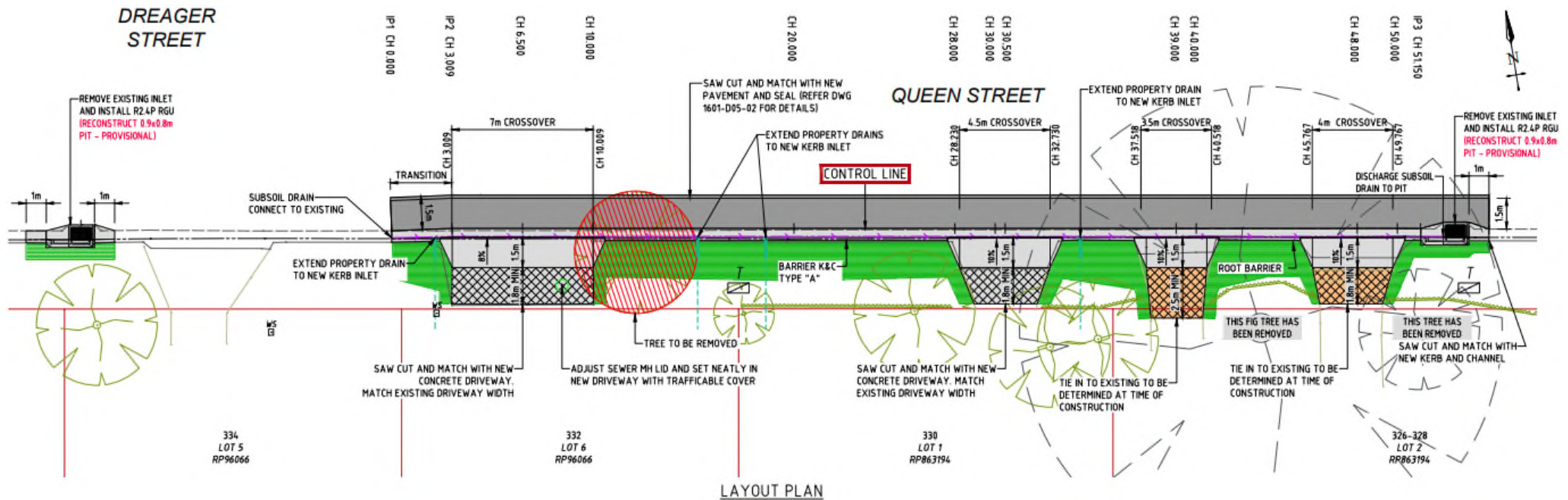

### LEGEND - NEW WORKS



NEW RESIDENTIAL DRIVEWAY  
SL72 MESH, 125mm THICK



NEW RESIDENTIAL DRIVEWAY  
(PROVISIONAL)



NEW PAVEMENT /SEAL



TOP SOIL & TURF



DRIVEWAY CROSSOVER



BARRIER K&C TYPE "A"



ROOF DRAIN EXTENSION  
AND KERB INLET



EXIST ROOF WATER DRAINS



SUBSOIL DRAIN



TREE TO BE REMOVED



## Kerb and Channel Sectional Replacement – Queen Street (326-332 Queen Street, Maryborough)

### PROJECT:

This project provides for the replacement of the kerb and channel on the southern side of Queen Street between 326 and 332 Queen Street, Maryborough.

The works are being undertaken as a result of Council's ongoing asset inspection program which identified that the kerb and channel was showing signs of failure and distress.

### PROJECT ESTIMATE:

\$150,000

### PROJECT SCOPE OF WORKS:

The project scope is as follows:

- Excavation and earthworks;
- Replacement of existing kerb and channel on the southern side of Queen Street between 326 and 332 Queen Street, Maryborough;
- Reconstruction of 4 existing vehicle crossovers at 326x2, 330 and 332 Queen Street Maryborough. *(Note: reinstatement works to be completed in plain concrete only);*
- Replacement of a section of driveway at 332 Queen Street and 330 Queen Street, Maryborough; *(Note: reinstatement works to be completed in plain concrete only);*
- Subsoil drainage works;
- Reconnection of stormwater to outlets;
- Construction of two new stormwater inlets in front of properties located at 334 Queen Street and 326 Queen Street;
- Removal of a tree on the footpath outside of 332 Queen Street, Maryborough;
- Topdressing and turfing of disturbed areas.



The traffic management plan that will be put in place for the duration of the construction period will be developed prior to works commencing.

#### INDICATIVE PROJECT MILESTONES

April 2025	Final Design
July 2025	Construction Period
Aug 2025	Project Completion

Note: Project milestones are subject to weather and may change.

## Kerb and Channel Sectional Replacement – 326-332 Queen Street, Maryborough

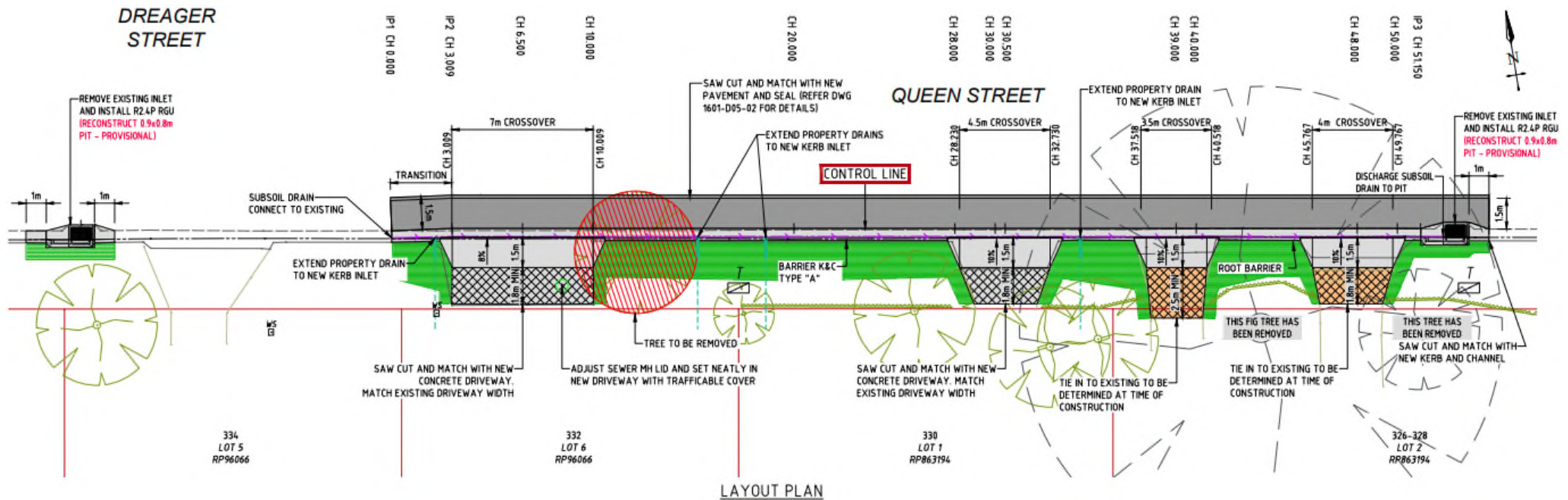

### LEGEND - NEW WORKS



NEW RESIDENTIAL DRIVEWAY  
SL72 MESH, 125mm THICK



NEW RESIDENTIAL DRIVEWAY  
(PROVISIONAL)



NEW PAVEMENT /SEAL



TOP SOIL & TURF



DRIVEWAY CROSSOVER



BARRIER K&C TYPE "A"



ROOF DRAIN EXTENSION  
AND KERB INLET



EXIST ROOF WATER DRAINS



SUBSOIL DRAIN



TREE TO BE REMOVED



## Kerb and Channel Sectional Replacement – Queen Street (326-332 Queen Street, Maryborough)

### PROJECT:

This project provides for the replacement of the kerb and channel on the southern side of Queen Street between 326 and 332 Queen Street, Maryborough.

The works are being undertaken as a result of Council's ongoing asset inspection program which identified that the kerb and channel was showing signs of failure and distress.

### PROJECT ESTIMATE:

\$150,000

### PROJECT SCOPE OF WORKS:

The project scope is as follows:

- Excavation and earthworks;
- Replacement of existing kerb and channel on the southern side of Queen Street between 326 and 332 Queen Street, Maryborough;
- Reconstruction of 4 existing vehicle crossovers at 326x2, 330 and 332 Queen Street Maryborough. *(Note: reinstatement works to be completed in plain concrete only);*
- Replacement of a section of driveway at 332 Queen Street and 330 Queen Street, Maryborough; *(Note: reinstatement works to be completed in plain concrete only);*
- Subsoil drainage works;
- Reconnection of stormwater to outlets;
- Construction of two new stormwater inlets in front of properties located at 334 Queen Street and 326 Queen Street;
- Removal of a tree on the footpath outside of 332 Queen Street, Maryborough;
- Topdressing and turfing of disturbed areas.



The traffic management plan that will be put in place for the duration of the construction period will be developed prior to works commencing.

INDICATIVE PROJECT MILESTONES	
April 2025	Final Design
July 2025	Construction Period
Aug 2025	Project Completion

Note: Project milestones are subject to weather and may change.

## Kerb and Channel Sectional Replacement – 326-332 Queen Street, Maryborough

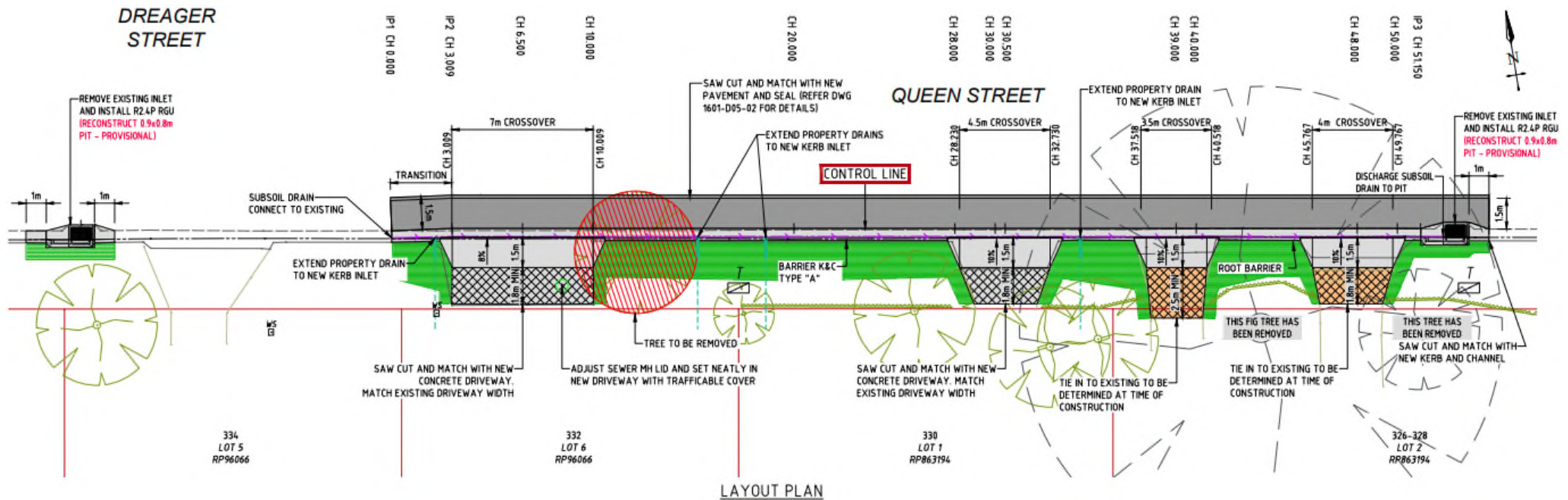



## Kerb and Channel Sectional Replacement – Queen Street (326-332 Queen Street, Maryborough)

### PROJECT:

This project provides for the replacement of the kerb and channel on the southern side of Queen Street between 326 and 332 Queen Street, Maryborough.

The works are being undertaken as a result of Council's ongoing asset inspection program which identified that the kerb and channel was showing signs of failure and distress.

### PROJECT ESTIMATE:

\$150,000

### PROJECT SCOPE OF WORKS:

The project scope is as follows:

- Excavation and earthworks;
- Replacement of existing kerb and channel on the southern side of Queen Street between 326 and 332 Queen Street, Maryborough;
- Reconstruction of 4 existing vehicle crossovers at 326x2, 330 and 332 Queen Street Maryborough. *(Note: reinstatement works to be completed in plain concrete only);*
- Replacement of a section of driveway at 332 Queen Street and 330 Queen Street, Maryborough; *(Note: reinstatement works to be completed in plain concrete only);*
- Subsoil drainage works;
- Reconnection of stormwater to outlets;
- Construction of two new stormwater inlets in front of properties located at 334 Queen Street and 326 Queen Street;
- Removal of a tree on the footpath outside of 332 Queen Street, Maryborough;
- Topdressing and turfing of disturbed areas.



The traffic management plan that will be put in place for the duration of the construction period will be developed prior to works commencing.

#### INDICATIVE PROJECT MILESTONES

April 2025	Final Design
July 2025	Construction Period
Aug 2025	Project Completion

Note: Project milestones are subject to weather and may change.

## Kerb and Channel Sectional Replacement – 326-332 Queen Street, Maryborough

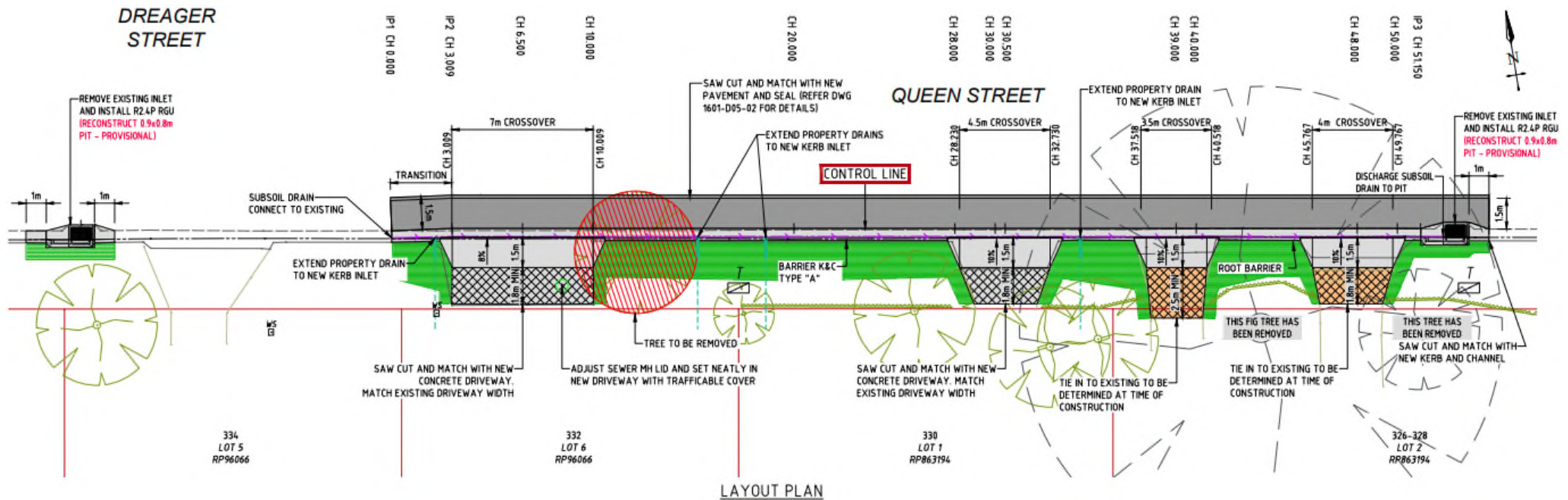

### LEGEND - NEW WORKS



NEW RESIDENTIAL DRIVEWAY  
SL72 MESH, 125mm THICK



NEW RESIDENTIAL DRIVEWAY  
(PROVISIONAL)



NEW PAVEMENT /SEAL



TOP SOIL & TURF



DRIVEWAY CROSSOVER



BARRIER K&C TYPE "A"



ROOF DRAIN EXTENSION  
AND KERB INLET



EXIST ROOF WATER DRAINS



SUBSOIL DRAIN



TREE TO BE REMOVED



## Kerb and Channel Sectional Replacement – Queen Street (326-332 Queen Street, Maryborough)

### PROJECT:

This project provides for the replacement of the kerb and channel on the southern side of Queen Street between 326 and 332 Queen Street, Maryborough.

The works are being undertaken as a result of Council's ongoing asset inspection program which identified that the kerb and channel was showing signs of failure and distress.

### PROJECT ESTIMATE:

\$150,000

### PROJECT SCOPE OF WORKS:

The project scope is as follows:

- Excavation and earthworks;
- Replacement of existing kerb and channel on the southern side of Queen Street between 326 and 332 Queen Street, Maryborough;
- Reconstruction of 4 existing vehicle crossovers at 326x2, 330 and 332 Queen Street Maryborough. *(Note: reinstatement works to be completed in plain concrete only);*
- Replacement of a section of driveway at 332 Queen Street and 330 Queen Street, Maryborough; *(Note: reinstatement works to be completed in plain concrete only);*
- Subsoil drainage works;
- Reconnection of stormwater to outlets;
- Construction of two new stormwater inlets in front of properties located at 334 Queen Street and 326 Queen Street;
- Removal of a tree on the footpath outside of 332 Queen Street, Maryborough;
- Topdressing and turfing of disturbed areas.



The traffic management plan that will be put in place for the duration of the construction period will be developed prior to works commencing.

#### INDICATIVE PROJECT MILESTONES

April 2025	Final Design
July 2025	Construction Period
Aug 2025	Project Completion

Note: Project milestones are subject to weather and may change.

## Kerb and Channel Sectional Replacement – 326-332 Queen Street, Maryborough

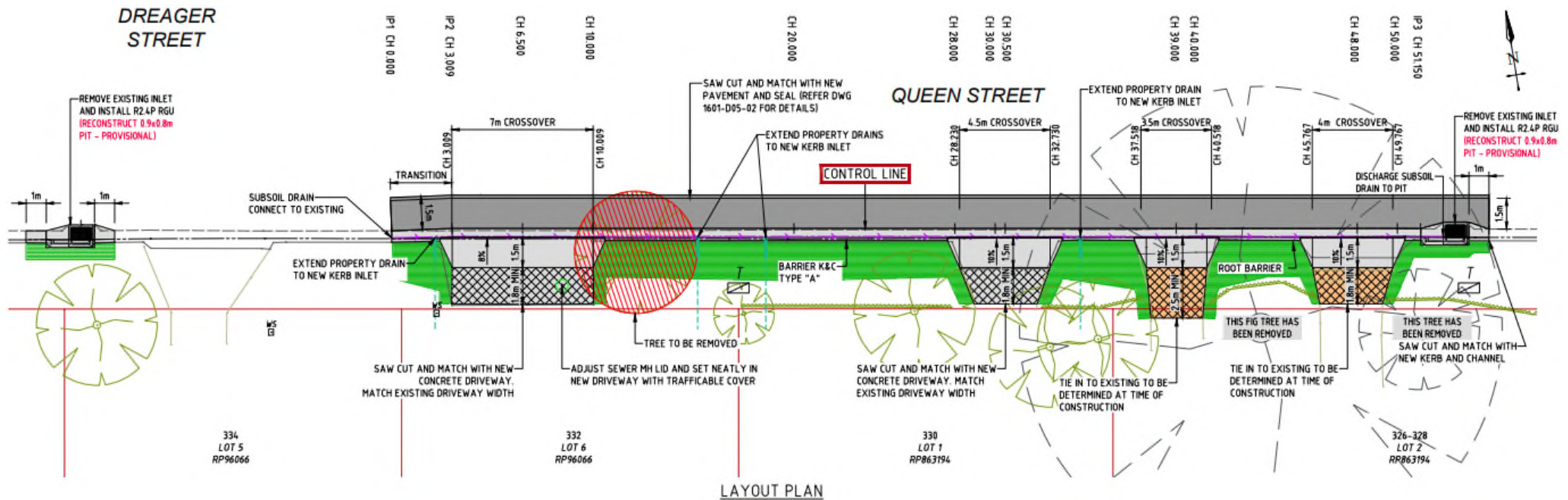

### LEGEND - NEW WORKS



NEW RESIDENTIAL DRIVEWAY  
SL72 MESH, 125mm THICK



NEW RESIDENTIAL DRIVEWAY  
(PROVISIONAL)



NEW PAVEMENT /SEAL



TOP SOIL & TURF



DRIVEWAY CROSSOVER



BARRIER K&C TYPE "A"



ROOF DRAIN EXTENSION  
AND KERB INLET



EXIST ROOF WATER DRAINS



SUBSOIL DRAIN



TREE TO BE REMOVED



## Kerb and Channel Sectional Replacement – Queen Street (326-332 Queen Street, Maryborough)

### PROJECT:

This project provides for the replacement of the kerb and channel on the southern side of Queen Street between 326 and 332 Queen Street, Maryborough.

The works are being undertaken as a result of Council's ongoing asset inspection program which identified that the kerb and channel was showing signs of failure and distress.

### PROJECT ESTIMATE:

\$150,000

### PROJECT SCOPE OF WORKS:

The project scope is as follows:

- Excavation and earthworks;
- Replacement of existing kerb and channel on the southern side of Queen Street between 326 and 332 Queen Street, Maryborough;
- Reconstruction of 4 existing vehicle crossovers at 326x2, 330 and 332 Queen Street Maryborough. *(Note: reinstatement works to be completed in plain concrete only);*
- Replacement of a section of driveway at 332 Queen Street and 330 Queen Street, Maryborough; *(Note: reinstatement works to be completed in plain concrete only);*
- Subsoil drainage works;
- Reconnection of stormwater to outlets;
- Construction of two new stormwater inlets in front of properties located at 334 Queen Street and 326 Queen Street;
- Removal of a tree on the footpath outside of 332 Queen Street, Maryborough;
- Topdressing and turfing of disturbed areas.



The traffic management plan that will be put in place for the duration of the construction period will be developed prior to works commencing.

#### INDICATIVE PROJECT MILESTONES

April 2025	Final Design
July 2025	Construction Period
Aug 2025	Project Completion

Note: Project milestones are subject to weather and may change.

## Kerb and Channel Sectional Replacement – 326-332 Queen Street, Maryborough

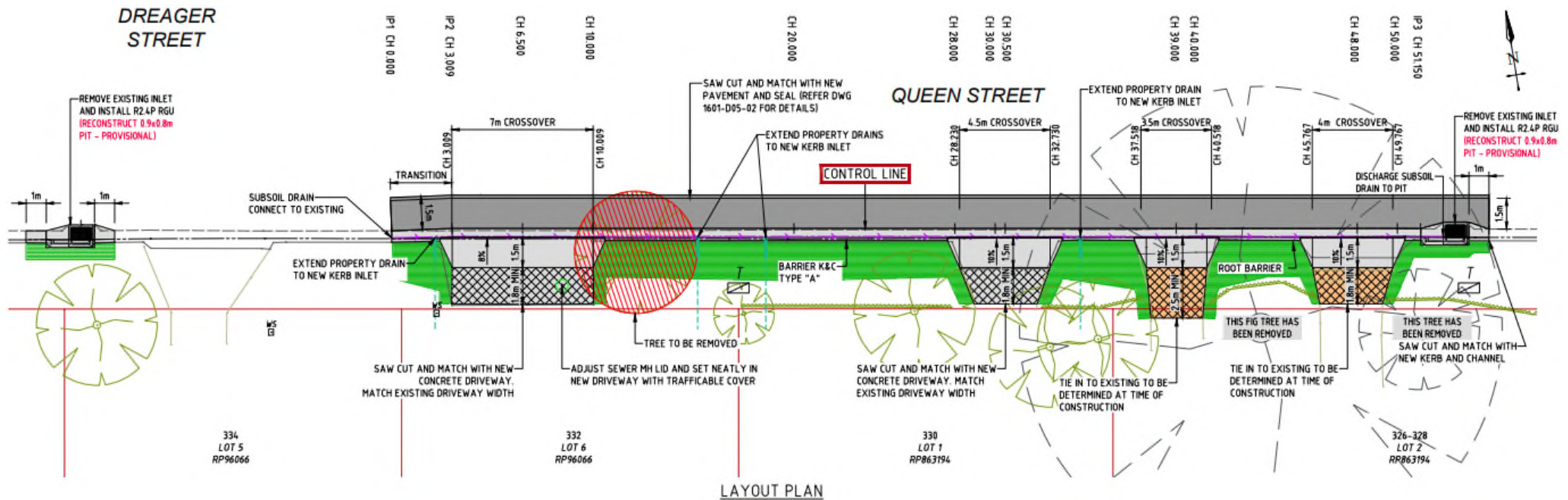

### LEGEND - NEW WORKS



NEW RESIDENTIAL DRIVEWAY  
SL72 MESH, 125mm THICK



NEW RESIDENTIAL DRIVEWAY  
(PROVISIONAL)



NEW PAVEMENT /SEAL



TOP SOIL & TURF



DRIVEWAY CROSSOVER



BARrier K&C TYPE "A"



ROOF DRAIN EXTENSION  
AND KERB INLET



EXIST ROOF WATER DRAINS



SUBSOIL DRAIN



TREE TO BE REMOVED



## Kerb and Channel Sectional Replacement – Queen Street (326-332 Queen Street, Maryborough)

### PROJECT:

This project provides for the replacement of the kerb and channel on the southern side of Queen Street between 326 and 332 Queen Street, Maryborough.

The works are being undertaken as a result of Council's ongoing asset inspection program which identified that the kerb and channel was showing signs of failure and distress.

### PROJECT ESTIMATE:

\$150,000

### PROJECT SCOPE OF WORKS:

The project scope is as follows:

- Excavation and earthworks;
- Replacement of existing kerb and channel on the southern side of Queen Street between 326 and 332 Queen Street, Maryborough;
- Reconstruction of 4 existing vehicle crossovers at 326x2, 330 and 332 Queen Street Maryborough. *(Note: reinstatement works to be completed in plain concrete only);*
- Replacement of a section of driveway at 332 Queen Street and 330 Queen Street, Maryborough; *(Note: reinstatement works to be completed in plain concrete only);*
- Subsoil drainage works;
- Reconnection of stormwater to outlets;
- Construction of two new stormwater inlets in front of properties located at 334 Queen Street and 326 Queen Street;
- Removal of a tree on the footpath outside of 332 Queen Street, Maryborough;
- Topdressing and turfing of disturbed areas.



The traffic management plan that will be put in place for the duration of the construction period will be developed prior to works commencing.

#### INDICATIVE PROJECT MILESTONES

April 2025	Final Design
July 2025	Construction Period
Aug 2025	Project Completion

Note: Project milestones are subject to weather and may change.

## Kerb and Channel Sectional Replacement – 326-332 Queen Street, Maryborough

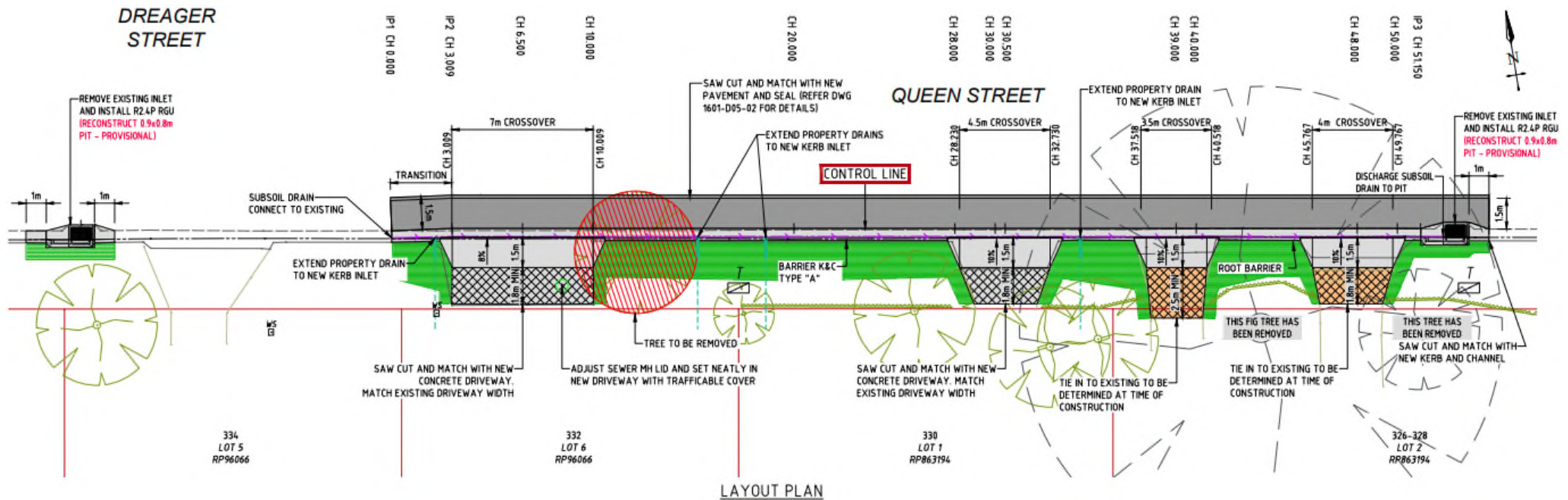

### LEGEND - NEW WORKS

	NEW RESIDENTIAL DRIVEWAY SL72 MESH, 125mm THICK		ROOF DRAIN EXTENSION AND KERB INLET
	NEW RESIDENTIAL DRIVEWAY (PROVISIONAL)		EXIST ROOF WATER DRAINS
	NEW PAVEMENT /SEAL		SUBSOIL DRAIN
	TOP SOIL & TURF		TREE TO BE REMOVED
	DRIVEWAY CROSSOVER		
	BARRIER K&C TYPE "A"		



## Kerb and Channel Sectional Replacement – Queen Street (326-332 Queen Street, Maryborough)

### PROJECT:

This project provides for the replacement of the kerb and channel on the southern side of Queen Street between 326 and 332 Queen Street, Maryborough.

The works are being undertaken as a result of Council's ongoing asset inspection program which identified that the kerb and channel was showing signs of failure and distress.

### PROJECT ESTIMATE:

\$150,000

### PROJECT SCOPE OF WORKS:

The project scope is as follows:

- Excavation and earthworks;
- Replacement of existing kerb and channel on the southern side of Queen Street between 326 and 332 Queen Street, Maryborough;
- Reconstruction of 4 existing vehicle crossovers at 326x2, 330 and 332 Queen Street Maryborough. *(Note: reinstatement works to be completed in plain concrete only);*
- Replacement of a section of driveway at 332 Queen Street and 330 Queen Street, Maryborough; *(Note: reinstatement works to be completed in plain concrete only);*
- Subsoil drainage works;
- Reconnection of stormwater to outlets;
- Construction of two new stormwater inlets in front of properties located at 334 Queen Street and 326 Queen Street;
- Removal of a tree on the footpath outside of 332 Queen Street, Maryborough;
- Topdressing and turfing of disturbed areas.



The traffic management plan that will be put in place for the duration of the construction period will be developed prior to works commencing.

#### INDICATIVE PROJECT MILESTONES

April 2025	Final Design
July 2025	Construction Period
Aug 2025	Project Completion

Note: Project milestones are subject to weather and may change.

## Kerb and Channel Sectional Replacement – 326-332 Queen Street, Maryborough

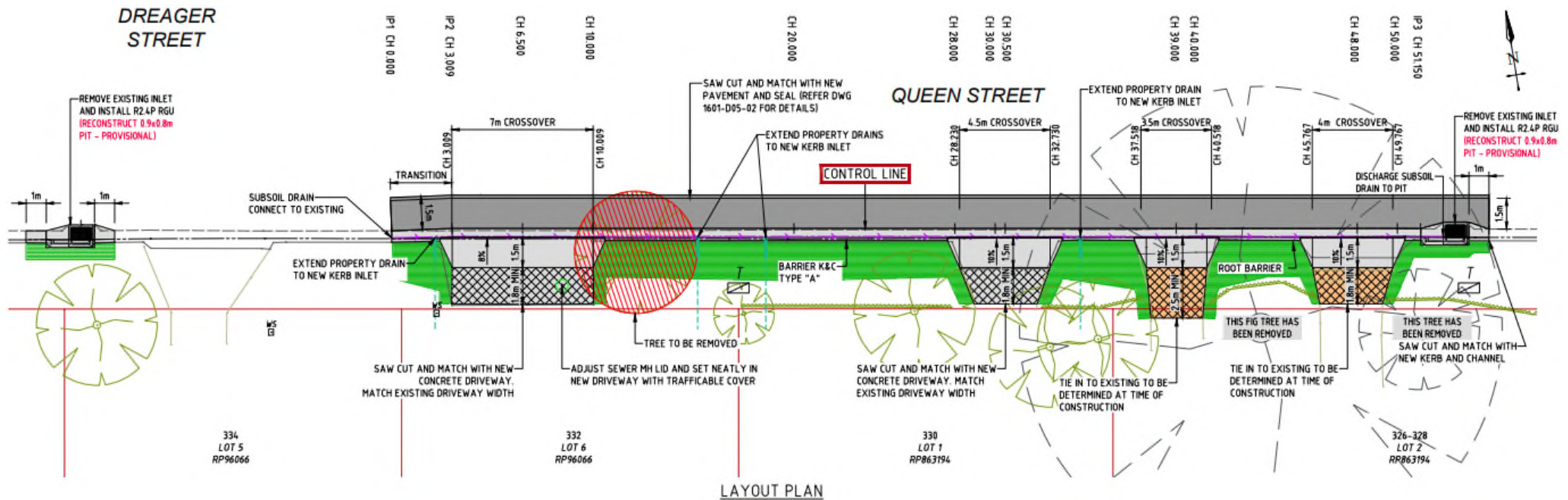



## Kerb and Channel Sectional Replacement – Queen Street (326-332 Queen Street, Maryborough)

### PROJECT:

This project provides for the replacement of the kerb and channel on the southern side of Queen Street between 326 and 332 Queen Street, Maryborough.

The works are being undertaken as a result of Council's ongoing asset inspection program which identified that the kerb and channel was showing signs of failure and distress.

### PROJECT ESTIMATE:

\$150,000

### PROJECT SCOPE OF WORKS:

The project scope is as follows:

- Excavation and earthworks;
- Replacement of existing kerb and channel on the southern side of Queen Street between 326 and 332 Queen Street, Maryborough;
- Reconstruction of 4 existing vehicle crossovers at 326x2, 330 and 332 Queen Street Maryborough. *(Note: reinstatement works to be completed in plain concrete only);*
- Replacement of a section of driveway at 332 Queen Street and 330 Queen Street, Maryborough; *(Note: reinstatement works to be completed in plain concrete only);*
- Subsoil drainage works;
- Reconnection of stormwater to outlets;
- Construction of two new stormwater inlets in front of properties located at 334 Queen Street and 326 Queen Street;
- Removal of a tree on the footpath outside of 332 Queen Street, Maryborough;
- Topdressing and turfing of disturbed areas.



The traffic management plan that will be put in place for the duration of the construction period will be developed prior to works commencing.

#### INDICATIVE PROJECT MILESTONES

April 2025	Final Design
July 2025	Construction Period
Aug 2025	Project Completion

Note: Project milestones are subject to weather and may change.

## Kerb and Channel Sectional Replacement – 326-332 Queen Street, Maryborough

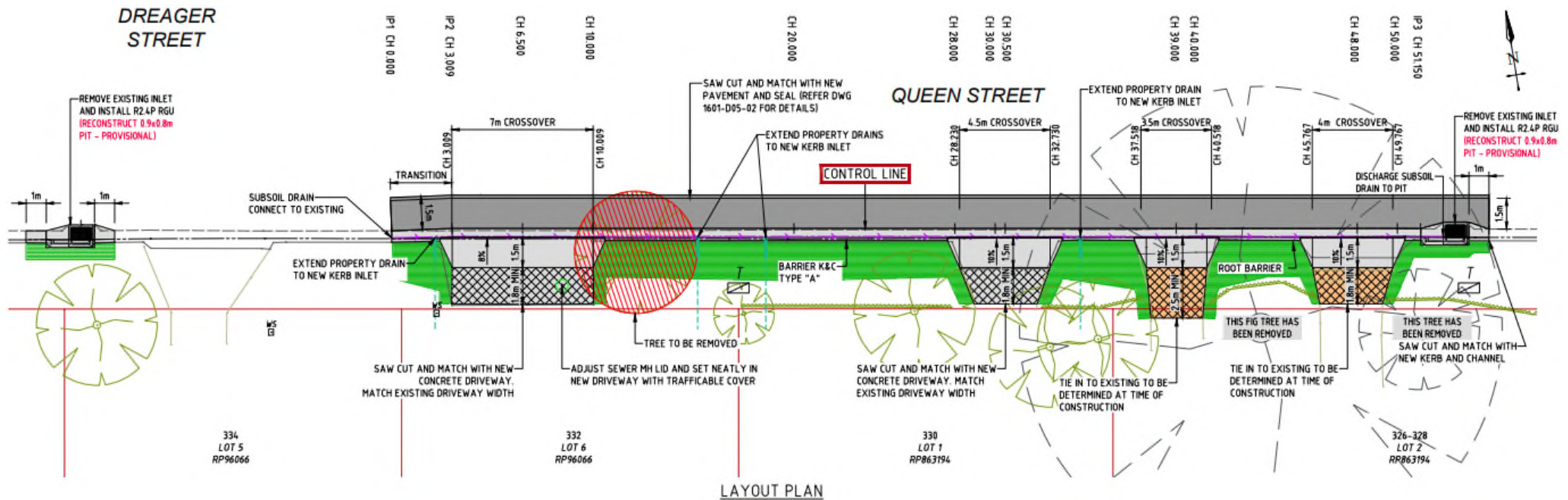

### LEGEND - NEW WORKS



NEW RESIDENTIAL DRIVEWAY  
SL72 MESH, 125mm THICK



NEW RESIDENTIAL DRIVEWAY  
(PROVISIONAL)



NEW PAVEMENT /SEAL



TOP SOIL & TURF



DRIVEWAY CROSSOVER



BARRIER K&C TYPE "A"



ROOF DRAIN EXTENSION  
AND KERB INLET



EXIST ROOF WATER DRAINS



SUBSOIL DRAIN



TREE TO BE REMOVED